

# New Student Notebook



## TEXAS WESLEYAN UNIVERSITY SCHOOL OF LAW



2008–2009

# new student

---

*notebook*

2008-2009

# table *of contents*

1. Welcome Letter from Dean White .....	4
2. Orientation	
(2a) Information from Academic Affairs .....	5
(2b) Orientation Schedule .....	7
(2c) Maps of Building.....	10
(2d) Bookstore Information .....	13
(2e) LARW Assignment for Orientation.....	14
(2f) Dee J. Kelly Law Library Tours.....	15
(2g) S.O.S.....	16
(2h) Getting Your Student ID Card .....	17
(2i) Orientation Protocol.....	18
(2j) Final Reminders.....	19
3. Law School Academics	
(3a) Academic Calendar .....	20
(3b) Dee J. Kelly Law Library Hours.....	21
(3c) Academic Support First Year Program.....	22
(3d) What Your Peers are Saying About Academic Support.....	23
(3e) First Year Course Schedule.....	24
(3f) Final Exam Schedule .....	25
(3g) Syllabi & Assignments for First-Year Classes.....	26
4. Law School Student Affairs	
(4a) Memorandum from Student Affairs.....	27
(4b) Student Affairs Office.....	28
(4c) Letter from Student Bar Association.....	29
(4d) Need Health Insurance? .....	30
(4e) Letter from Admissions.....	31
5. Financial Aid & Financial Services	
(5a) Letter from Financial Aid .....	32
(5b) Business Office .....	33
6. Parking Regulations.....	34
(6a) Transportation .....	35
7. Texas Board of Law Examiners	
(7a) Declaration of Intent to Study Law.....	36
(7b) Message from the Texas Board of Law Examiners.....	37
(7c) Fingerprinting & Photographing.....	38
8. Letter from Career Services.....	39
9. Letter from Law Review.....	40
10. Contact Information - Phone Directory.....	42

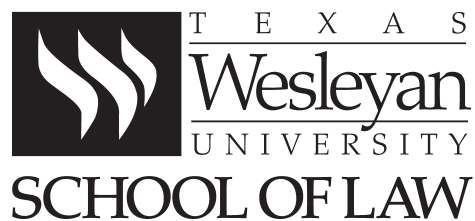

From Dean White

Dear Entering Student:

Welcome! On behalf of the law school community, it is my pleasure to welcome you to Texas Wesleyan University School of Law. We are delighted that you have decided to attend law school here.

It has taken dedication and perseverance for you to be where you are today, and we are committed to helping you achieve your educational and professional goals. Our faculty, staff, and administration are dedicated to helping you as you embark on this journey. Our commitment to you is simple: we will continuously work to provide you with the best legal education possible. We are constantly developing new programs and integrating innovative ideas to enhance your educational experience at Texas Wesleyan University School of Law.

Your first year of law school will be an exciting and challenging experience. Everything you learn at Texas Wesleyan is designed to provide you with the intellectual, professional, and practical skills necessary to meet the challenges that will confront you during your career in the legal profession.

We have every confidence that you will be a successful law student and, ultimately, make a positive contribution to the legal profession. We wish you the very best in the upcoming year and throughout your legal education, and we are looking forward to working with you during your years here at the law school, as well as throughout your legal career.

Please do not hesitate to contact me or any member of the faculty or staff if we can be of any assistance to you. I look forward to personally welcoming you in August.

Best regards,

Frederic White  
Dean and Professor of Law

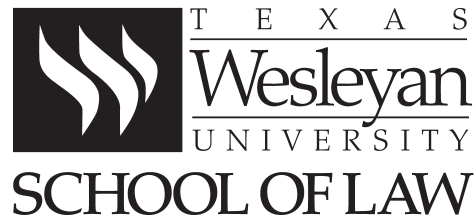

From Associate Dean for Academic Affairs:

Welcome to Texas Wesleyan University School of Law! This memo contains important information to prepare you for the beginning of your law school career.

#### Orientation

Attendance at Orientation is mandatory; if you cannot attend, please contact me at [vrainwater@law.txwes.edu](mailto:vrainwater@law.txwes.edu). Please consult this notebook for a detailed schedule of Orientation activities.

#### THURSDAY, AUGUST 14

- Day students: Arrive at 3:30 PM on Thursday, August 14th. The program for day students ends at 6:00, after which there will be a reception in the Courtroom.
- Evening students: Arrive at 3:30 PM on Thursday, August 14th. The first part of the program for evening students ends at 6:00, after which there will be a dinner in the Conference center. The program for evening students continues from 7:00-9:45.

#### FRIDAY, AUGUST 15

- Day students: Arrive at 9:00 AM and depart by 5:00 PM.
- Evening students: There is no program for evening students on Friday.

#### SATURDAY, AUGUST 16

- Day students: Arrive at 11:30 AM and depart by 1:30, or stay for SOS program sponsored by Student Bar Association from 1:30-2:45.
- Evening students: Arrive at 8:15 AM and depart by 1:30, or stay for SOS program sponsored by Student Bar Association from 1:30-2:45.

The meals on the Orientation schedule will be provided to you by the law school.

#### Classes during Orientation:

You will attend two classes during Orientation—Hierarchy of Authority, taught by the law librarians; and Introduction to Legal Analysis, Research, & Writing, taught by the LARW faculty. Instruction in the Hierarchy of Authority class and in the Introduction to LARW class is part of the 42 hours of instruction you will receive in LARW this fall, so your attendance is vital. For the LARW class, you have a homework assignment, which is detailed elsewhere in this notebook.

#### Other Activities

- Stations: you will meet representatives from Student Organizations, obtain information about Career Services, Computing Services, have your ID photo made, etc. You will also take a library orientation tour. (This is a mandatory orientation—it is different from a tour you might have received from the Admissions office.) You will attend the library tour for your LARW section. Your fall schedule, which you will receive by email later in the summer, will show you which LARW section you are in.
- How to Study Law: This lecture, taught by our faculty, will discuss the best and most efficient study methods for law school.

- SOS—Student and Significant Other Survival: This panel discussion with students and students' family members is for you and your spouse, family members, and significant others. Panelists will discuss what life changes to expect while you are a law student and how you can all keep your relationships healthy during law school.

#### Law School Policies and Procedures

Later this summer the Student Programs, Policies, & Procedures manual for 2008-09 will be available on our web page. It is very important that you read the manual, paying particular attention to the Academic Standards and the Student Code of Conduct. During Orientation, you will be required to sign a statement that you have received and read the manual.

#### Bring with you for Orientation

- Your Romantz and Vinson book and your Bluebook (see LARW Assignment)

#### Parking for Orientation

Refer to page 34

If you will not be joining us this August, please let us know immediately by calling the Office of Admissions at 817-212-4040, so we can offer your place to another candidate.

I look forward to welcoming you personally on August 14th. I am confident you will have an exciting and enriching experience at Texas Wesleyan University School of Law.

Vickie Rainwater

Associate Dean for Academic Affairs

## Orientation

**Thursday, August 14, 2008 - All Students**

3:30 - 4:00 p.m.	Registration.....	Pre-Conference Area (Second floor, outside the Lecture Hall)
4:00 - 5:00 p.m.	Welcome and Introductions..... Frederic White, Dean Texas Wesleyan School of Law Roland Johnson, President-Elect State Bar of Texas Judge Terry Means U.S. District Court - Northern District of Texas	Lecture Hall
5:00 - 5:10 p.m.	Break	
5:10 - 6:00 p.m.	Nuts and Bolts of Law School .....	Lecture Hall
6:00 - 7:00 p.m.	Dinner (Evening Students).....  Mandatory Library Tours for Evening Students: Library Tour Schedule: See Page 15	Conference Center (Second floor, across from Lecture Hall)
6:00 - 7:00 p.m.	Reception (Day Students) .....	Courtroom Complex (First floor)
7:00 - 9:45 p.m.	Intro to Legal Analysis, Research, & Writing Evening Section 9: See Page 14 .....	Room 201 Room 202 Room 212

## Orientation

### Friday, August 15, 2008 - Day Students

9:00 - 10:50 a.m.	Hierarchy of Authority	
	Day Sections 1, 2, 3.....	Room 202
	Day Sections 4, 5, 6.....	Room 201
	Day Sections 7, 8 .....	Room 204
10:50 - 11:00 a.m. Break		
11:00 - 12:20 p.m.	Intro to Legal Analysis, Research, & Writing	
	Day Sections 1 and 7: See Page 14.....	Room 201
	Day Sections 2 and 8: See Page 14.....	Room 204
	Day Section 3: See Page 14.....	Room 202
	Day Section 4 and 5: See Page 14.....	Room 207
	Day Section 6: See Page 14.....	Room 212
12:20 - 1:00 p.m.	Lunch.....Conference Center (Second floor, across from Lecture Hall)	
1:00 - 2:20 p.m.	Continuation of Intro to Legal Analysis, Research, & Writing ..... Same room assignments	
2:20 - 2:30 p.m.	Break	
2:30 - 3:30 p.m.	How to Study Law	
	Day Sections 1, 2, 3, 4.....	Room 202
	Day Sections 5, 6, 7, 8.....	Room 204
3:30 - 5:00 p.m.	Stations:	
	Mandatory Library Tours for Day Students: See Page 15. ....	Library
	Computers.....	Room 211
	Student I.D. Cards and Parking .....	Room 205

## Orientation

### Saturday, August 16, 2008 - All Students

8:15 - 9:20 a.m.	How to Study Law Evening Sections 9, 10, 11 .....	Lecture Hall
9:20 - 9:30 a.m.	Break	
9:30 - 11:20 a.m.	Hierarchy of Authority Evening Section 9..... Evening Section 10 .....	Room 201 Room 202
	Evening Section 11.....	Room 204
11:20 - 11:30 a.m.	Break	
11:30 - 12:30 p.m.	Opportunities Outside the Classroom All Sections (Day and Evening) .....	Lecture Hall
12:30 - 2:00 p.m.	Lunch - All sections .....	Conference Center (Second floor, across from Lecture Hall)
12:30 - 1:30 p.m.	Stations: Mandatory Library Tour for Transfers & Visitors..... Computers..... Student I.D. Cards and Parking .....	Library Room 211 Room 205
	Student Organizations - all sections.....	Courtroom (First floor)
1:30 - 2:45 p.m.	S.O.S: See Page 16..... Student & Significant Other Survival Seminar	Lecture Hall

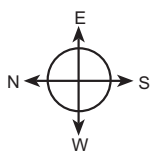
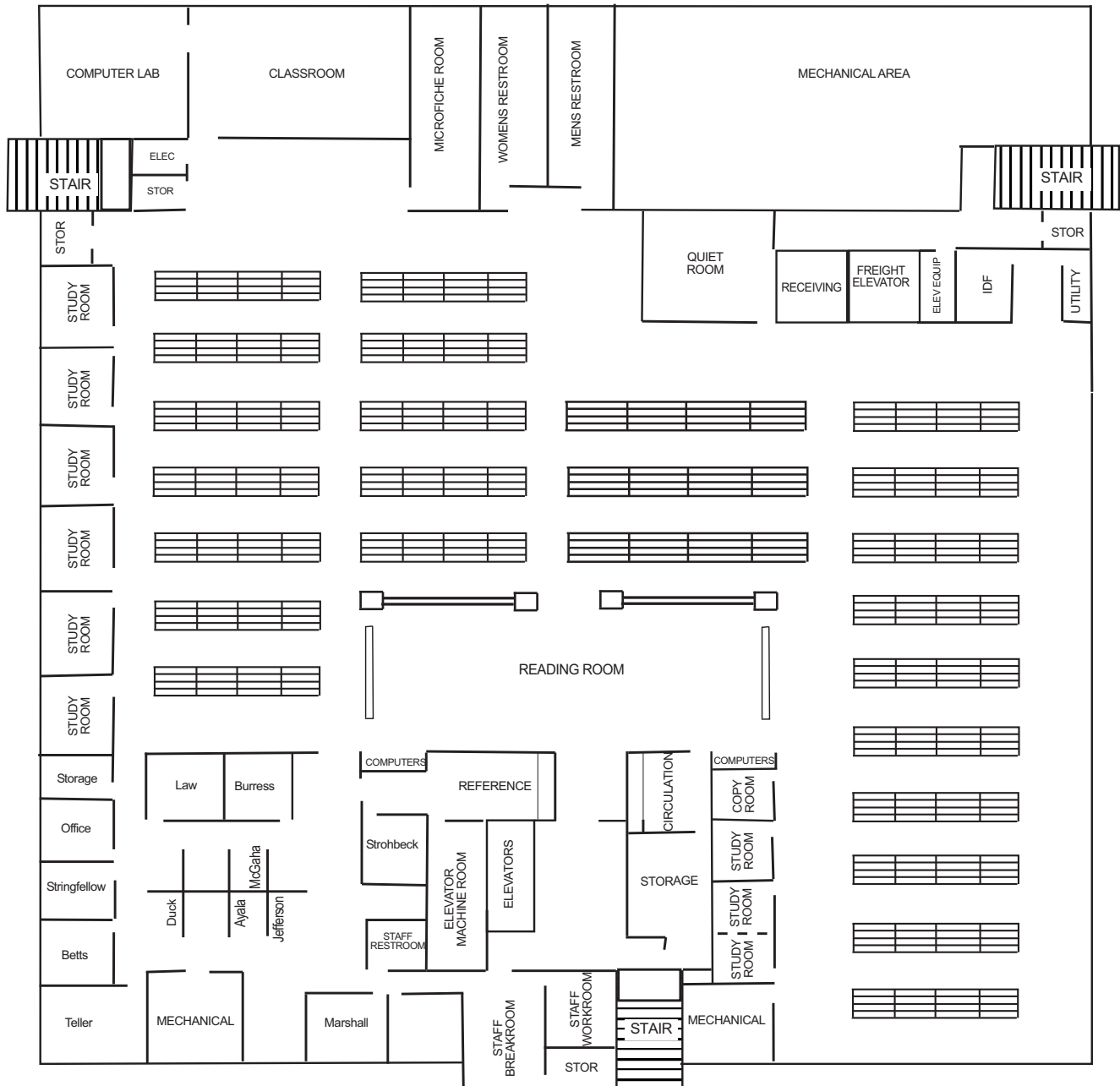
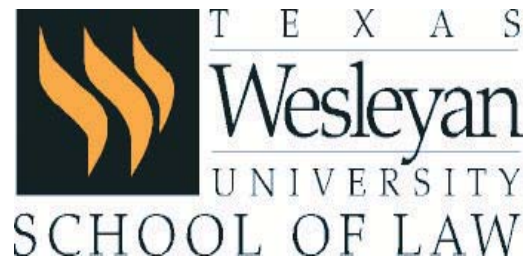

# LAW LIBRARY

## Lower Level

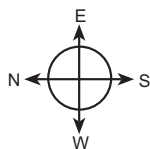
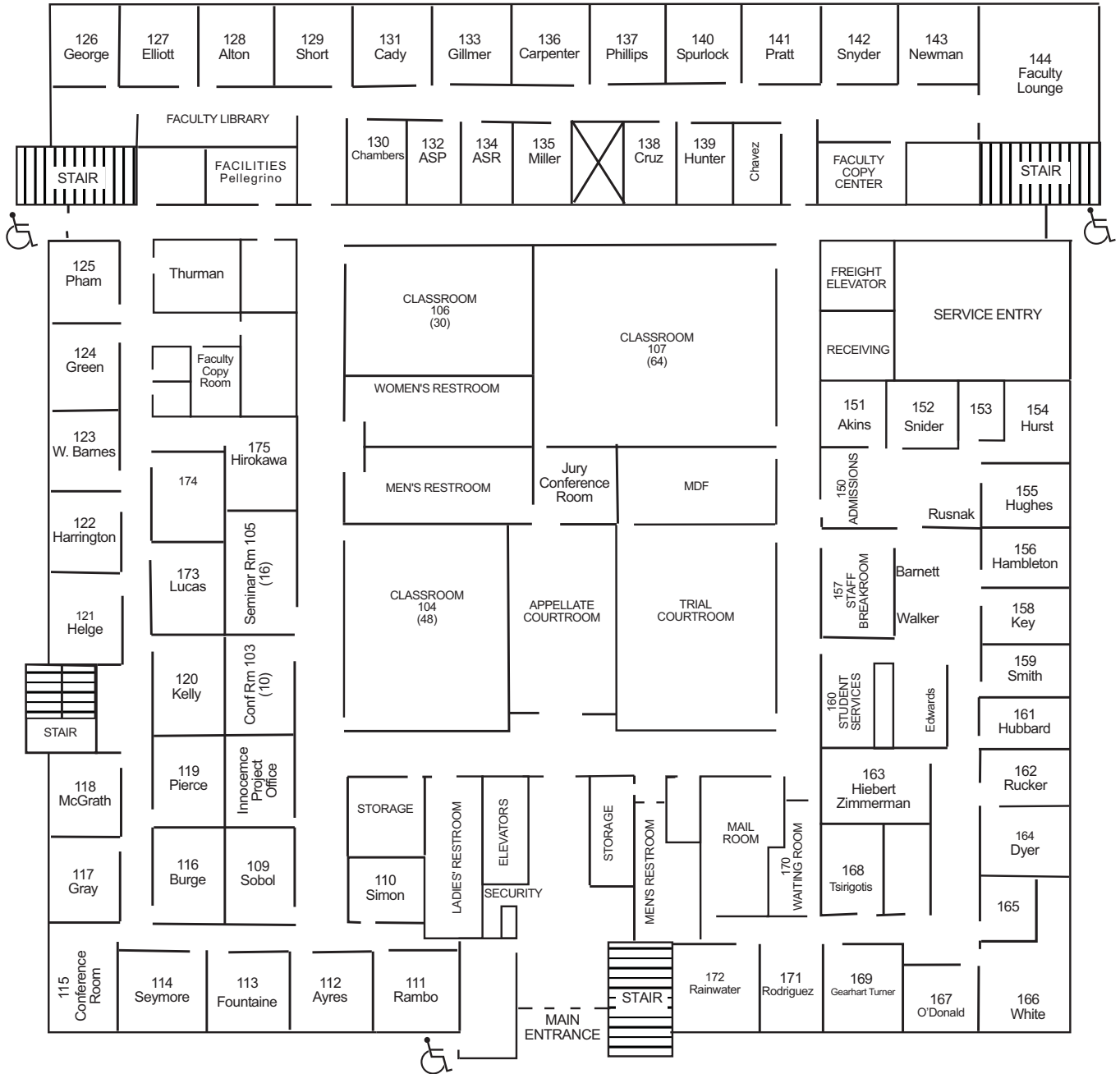

# First Floor

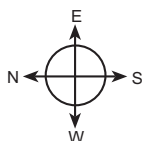
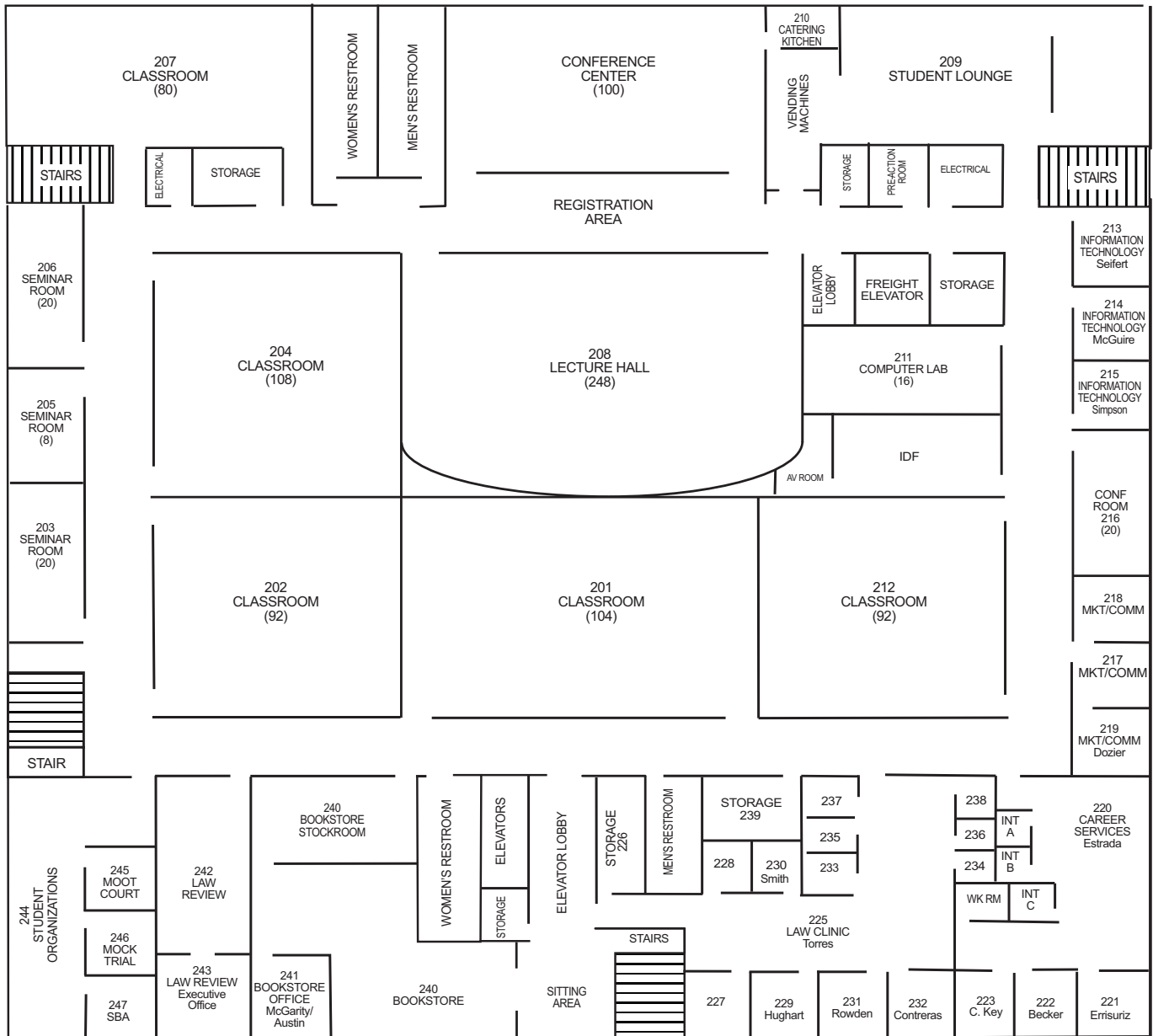

# Upper Level

## Bookstore Information

### Hours of Operation

through August 9th:

Monday-Thursday: 9:00 a.m. – 5:00 p.m.

Friday: 9:00 a.m. – 3:00 p.m.

Saturday: 10:00 a.m. – 3:00 p.m.

Sunday: closed

### Beginning August 11th:

Monday-Thursday: 9:00 a.m. – 6:30 p.m.

Friday: 9:00 a.m. – 3:00 p.m.

Saturday: 10:00 a.m. – 3:00 p.m.

Sunday: closed

We accept Visa, MasterCard, Discover, American Express,  
personal checks, and of course, cash.

We are located on the second floor of the Law School, to the right as you exit the elevator.

Phone: 817.212.4070

Fax: 817.212.4074

e-mail: pmcgarity@law.txwes.edu

Manager: Patricia McGarity

Asst: Terry Austin

and our student employees;

Heather, Erika, Vicki, Garrick, Lindsay, Nicki, Adrianna, plus a host of alumni that stop by and love to chat!

Important! You will need to read **Legal Analysis: The Fundamental Skill**, by David S. Romantz & Kathleen Elliott Vinson (Carolina Academic Press); \$17 and **The Bluebook: A Uniform System of Citation, 18ed.** (Harvard Law Review); \$25 for Orientation. If you are unable to come to the store, we will be happy to mail the book to you via US First Class mail for an additional charge of \$5.80.

Your required course books are available with one or two exceptions because of updates. You will need your section assignments to purchase your books, as different professors use different materials for the same course. **We want to encourage you to come in as early as possible purchase to your books and to let us show you around.** Students can expect to pay \$200 per class for books. Don't panic; these are for two semester classes, with one exception.

There is a myriad of "study aids" on the market today. These are hornbooks, nutshells, course outlines, case-briefs, flash cards, lectures on CD, etc. We recommend that you wait until you have been in class for a couple of weeks before you purchase any study aids. Please feel free to ask us about any of them. In addition to books, we also carry apparel, gifts, and snacks.

**Return Policy: You must have your receipt for all returns!**

Fall semester: last day to return your course books is Friday, September 5th. You will receive a full refund at that time if you have not written in the book. Study aids are not returnable (that's why we want you to choose carefully). CDs and flash cards may be returned within 30 days with the shrink wrap plastic intact. Gifts and other items may be returned within 30 days with receipt.

We look forward to meeting you and serving you!

## LARW Assignment for Orientation

Before Orientation, buy:

- Legal Analysis: The Fundamental Skill, by David S. Romantz and Kathleen Vinson and
- The Uniform System of Citation (the "Bluebook"). These books are available in the law-school bookstore; if you are unable to come to the bookstore, please call 817.212.4070 and ask that the books be mailed to you.

For your LARW class (which meets on Thursday for Evening students and Friday for Day students) read Chapters 1, 2, 3, & 7 of the Romantz and Vinson book. We will discuss the problems after each chapter in class. You will not hand in the answers to the problems, but you should write out answers to use during the class discussion. You will be called on to recite in class. Be prepared!

For your Hierarchy of Authority class (Friday for Day students and Saturday for evening students), there is no reading assignment, but be sure to bring your Bluebook.

## Dee J. Kelly Law Library Orientation

As part of your first-year orientation, you will be participating in a Law Library Orientation that will provide you with necessary information on using the library, including passwords for the library computer lab and safety instructions for the compact shelving. This orientation is required and is different from the library tour you may have received through the Admissions Department.

Please arrive at the law library on the lower level of the building at the time designated by your writing section. Your cooperation and prompt arrival will ensure that everyone receives necessary information about the library.

Thursday, August 14: 6:00 p.m. – 7:00 p.m.

Section 9	6:15
Section 10	6:30
Section 11	6:45

Friday, August 15: 3:30 p.m. – 5:00 p.m.

Section 1	3:30
Section 2	3:42
Section 3	3:54
Section 4	4:06
Section 5	4:18
Section 6	4:30
Section 7	4:42
Section 8	4:54

Saturday, August 16: 12:30 p.m. – 12:45 p.m.

Transfers, Visitors, and Make-Ups: 12:30

## **The Student Bar Association**

### **Invites you and your significant other to the S.O.S. (Student and Significant Other Survival Seminar)**

Saturday, August 16, 2008  
1:30 – 2:45 p.m.  
Amon G. Carter Lecture Hall

Attending law school will be demanding, exciting, intellectually challenging - and stressful!

With law school comes massive reading, time away from home and family, deadlines, and the ever present demand to study. This seminar will help you and your significant other understand how current law students cope with these demands. A panel of students will share survival techniques and shed light on what to expect as you enter the study of law; and we will offer a dose of humor to cope with it all!

Speakers will include:

- A traditional single student
- A married student
- A non-traditional student
- An evening student
- A spouse of a law student

## Getting Your Student ID Card

First-Year Students:

All Texas Wesleyan law school students are required to obtain and carry a picture ID. You will use the ID Card as your library card during your time at the law school and for access to security system controlled areas of the facility. The picture taken for your ID Card will also be used for our pictorial directory.

A Student ID Card station will be set up during Orientation according to the schedule contained in this online notebook. However, you are also welcome to stop by Student Services any time you have business at the law school and have your picture made for your ID Card. That will save you waiting in a long line during Orientation.

If you have any questions concerning this process, please contact the law school facilities manager, Becky Key, at 817-819-1444.

## Orientation Protocol

### 1. Can my spouse come to orientation too?

Orientation is for students only.

### 2. Who attends the SOS seminar?

The SOS law school survival seminar, scheduled for Saturday, August 16th from 1:30 to 2:45 p.m. in the Amon G. Carter Lecture Hall (second floor), is open to spouses and significant others.

### 3. Where do I go the first day?

Orientation will be held in the law school at 1515 Commerce Street, Fort Worth, Texas. Registration will begin at 3:30 p.m. Thursday, August 14th for all students. Please come to the second floor, Amon G. Carter Lecture Hall.

### 4. What do I wear?

We request that you dress in business casual for orientation. You will have your picture taken for your school I.D. that day and that picture will be used on the law school website, so you'll want to look your best!

### 5. Where do I park?

You may park in either Lot A or C during orientation and not worry about being ticketed or towed. If you require a handicapped parking space, you can obtain a handicap permit at the Office of Student Services.

### 6. Can I get fingerprinted before orientation?

No. Please refer to fingerprinting and photographing section.

### 7. How do I contact student organization leaders?

Student organizations will have representatives in the courtroom (first floor) on Saturday, August 16 from 12:30 to 1:30 p.m. at the Student Organization Fair. Stop by to visit and learn about each of the groups.

## Final Reminders

- Contact Dean Rainwater at [vrainwater@law.txwes.edu](mailto:vrainwater@law.txwes.edu) if you have a schedule conflict with your Orientation days.
- Bring your Romantz and Vinson book for LARW class.
- Bring your Bluebook for Hierarchy of Authority class.

## Academic Calendar

### Fall Term 2008

First-Year Orientation | August 14-16

Classes Begin | August 18

Labor Day | September 1

Thanksgiving Break | November 26-28

Classes End | November 24

Exam Period | December 1-11

Hooding & Commencement Ceremony | December 12

### Spring Term 2009

Classes Begin | January 12

M.L. King Day | January 19

Spring Break | March 16-20

Good Friday | April 10

Classes End | April 28

Exam Period | May 4-May 14

Hooding & Commencement Ceremony | May 15

## Dee J. Kelly Law Library

Search the online catalog at  
<http://library.txwes.edu>.

Regular semester Law Library hours:

Monday-Friday 7:30 am – Midnight

Saturday 9:00 am – Midnight

Sunday 10:00 am – Midnight

Hours are subject to change.

For current library hours, check the Dee J. Kelly Law Library homepage at  
<http://law.txwes.edu/lawlibrary>.

## Academic Support – First Year Program

### WHAT IS ACADEMIC SUPPORT?

The Academic Support program is designed by the law school especially for you, the first-year student. You will be assigned to meet in a weekly study group with an upper-level student who is your Teaching Assistant. We have chosen the TAs with care, so all are well qualified to be of real help to you. Our main goal is to work hand in hand with you so you can march into your second year with the best possible grades.

Our teaching assistants are the heart of the first-year academic support program. These upper-level students are chosen for their academic achievements as well as for their teaching and mentoring skills. Under the supervision of the director and assistant director they will offer guidance to you in everything from balancing life and law school to conquering law school exams. They lead weekly study groups that cover a variety of skills critical to success in law school, and they also provide peer mentoring to first-year law students.

We in Academic Support consider ourselves the helpful how-to people. Here is some of the help you can expect from us:

- How to read and brief cases in preparation for your classes
- How to do legal analysis
- How to write the outlines that you'll use to study for exams
- How to prepare for exams
- How to write exams and
- How to balance your demanding schedule.

The director and his assistant, as well as your teaching assistants, make themselves available to answer your questions and to assist you during their office hours. They are also available for conferences by appointment.

#### Practice Exams

In both the fall and spring, the academic support program administers practice exams under actual test-day conditions. Professors of first-year subjects frequently create sample exams and they also provide representative sample answers. Students who take the practice exams receive written critiques from the teaching assistants.

#### Seminars

The program puts on several seminars that are of special interest to law students. Throughout the year, Everett Chambers, the Academic Support Director (a TWU graduate), the Assistant Director, Marta Miller (also a TWU graduate), and a panel of professors will give talks and conduct workshops to help you strengthen your learning and study skills. The input from your professor during the "professor panels" will be especially useful as you get ready for your final exams. You will also receive an orientation to the structure of the Texas Bar Exam and advice for choosing classes to increase your probability of being successful on the bar exam.

Attendance at the study groups is not mandatory, but we urge you to attend. At each session our main focus is to get you ready to do well on your final exams. Most students find these study groups immensely helpful (see student comments). Some even attribute their high GPAs to participation in the program. As you know, you are about to navigate some very treacherous waters. We in Academic Support want to help you to develop the skills, knowledge, and confidence that you can use to navigate a safe passage into the second year. You have made a significant investment of time and money. Please allow us to help you protect and grow your investment into something that brings you satisfaction. Your hard work must pay off with good first-year grades. Accept our offer to help you succeed.

You don't need to sign up—just show up at the study group! During the first week of school your TA will visit you in your writing class to tell you when and where your study group will meet.

Good luck and  
Welcome to Texas Wesleyan University School of Law!

## What Your Peers Are Saying About Academic Support

Entering into your 1L year of law school can be an overwhelming experience. Because I did not have an extensive law background or the highest LSAT scores coming into my 1L year, I knew that I had to take advantage of every opportunity available to be successful in law school. Consistently participating in the Academic Support groups every week and applying the skills and techniques learned in the AS sessions to my studies paid off immensely when I received my grades at the end of the semester. I would not have been as successful in my 1L year without AS.

Damian Gomez 2L

The trouble with first year law school was the huge amount of information I needed to absorb. Mostly, it went in one ear and out the other. Academic Support placed a figurative "plug" in the offending ear and helped me retain material that I needed for exams.

Bernie Schuchmann, Recent Graduate, Former TA

The help from academic support brought my grades up one full letter grade in each of my classes, making my 1L year a success.

Ron Herrmann, Recent Graduate, Former TA, JAG Officer

During my 1L year, I blew off AS and did not participate in any of the groups. The result was that I dug myself into a massive hole. Fortunately, I was able to turn to AS for help as I tried to dig myself out. By participating in the weekly groups, I could have avoided the misery! I strongly recommend the program to entering students.

Repentant Graduate, Solo Practitioner

It's hard to stay motivated when you think your grades don't reflect your effort. It's also not easy to force yourself to attend the weekly academic support groups, especially when you hear others saying that it's a waste of time. But the hour spent each week that sometimes felt so tedious DID help. Eventually I brought my semester G.P.A. up more than a whole point. I am very thankful that academic support was available to me.

Wendy Nichole Flanigan—recently passed the bar exam

Before law school, I always thought of myself as being organized. After only one week of law school, I realized that however great my organizational skills were, they were not going to cut it in law school. That is when I turned to Academic Support. I think of it as law school survival for the 1Ls. Academic Support taught me how to stay organized, take notes, and even gave me the scoop on what my professors would look for in exams. I have no doubt that it was an excellent investment of my time.

Rosie Berdeja – Part-time evening student

The first year of law school is a roller coaster ride. It is easy to lose sight of your goals . . . and your sanity. Academic Support taught me how to organize and manage the enormous amount of information I learned each day, while also maintaining a life outside of law school.

Audra Heinze-2L

**First Semester Full-time and Part-time Lockstep Sequence, DAY DIVISION, Fall 2008 Term**

Monday	Tuesday	Wednesday	Thursday	Friday
<u>10:00-11:50</u> Torts §1 Gillmer §2 Harrington	<u>10:30-11:45</u> Legal Analysis, Research, & Writing I §1 Sobol §2 Pierce §3 Simon §4 Burge  Civil Procedure §2 Fountaine	<u>10:00-11:50</u> Torts §1 Gillmer §2 Harrington	<u>10:30-11:45</u> Legal Analysis, Research, & Writing I §1 Sobol §2 Pierce §3 Simon §4 Burge  Civil Procedure §2 Fountaine	
		Noon Break		
<u>1:30-2:45</u> Property §1 Short §2 Carpenter  <u>3:00-4:15</u> Contracts §1 Barnes §2 Snyder	<u>1:30-2:45</u> Legal Analysis, Research, & Writing I §5 Burge §6 Kelly §7 Sobol §8 Pierce  Civil Procedure §1 Fountaine	<u>1:30-2:45</u> Property §1 Short §2 Carpenter  <u>3:00-4:15</u> Contracts §1 Barnes §2 Snyder	<u>1:30-2:45</u> Legal Analysis, Research, & Writing I §5 Burge §6 Kelly §7 Sobol §8 Pierce  Civil Procedure §1 Fountaine	

**First Semester Part-time Lockstep Sequence, EVENING DIVISION, Fall 2008 Term**

Monday	Tuesday	Wednesday	Thursday	Friday
<u>6:30-7:45</u> Contracts I §3 Spurlock	<u>6:30-7:45</u> Legal Analysis, Research, & Writing I §9 Simon §10 Kelly §11 Hambleton		<u>6:30-7:45</u> Legal Analysis, Research, & Writing I §9 Simon §10 Kelly §11 Hambleton	
<u>8:00-9:50</u> Torts §3 McGrath	<u>8:00-9:15</u> Contracts I §3 Spurlock		<u>8:00-9:50</u> Torts §3 McGrath	

**TEXAS WESLEYAN UNIVERSITY  
SCHOOL OF LAW**

**Final Examination Schedule Fall 2008**

Please consider the final exam schedule carefully when registering for classes. Please consult *Academic Standards* for the rules about rescheduling exams. The Associate Dean for Academic Affairs must approve requests to reschedule exams. Rescheduled exams will be administered as soon as possible after the scheduled time. No exams will be given before the scheduled time. Students who are entitled to reasonable accommodations under the Americans with Disabilities Act must arrange for accommodations with the Assistant Dean of Student Affairs.

<b>Monday, December 1</b>	<b>Thursday, December 4</b>	<b>Tuesday, December 9</b>
<b>9:00 am</b> Civil Procedure §1 & §2 Immigration Law Patents	<b>9:00 am</b> Contracts §1 & §2	<b>9:00 am</b> No Exams
<b>1:30 pm</b> Employment Discrimination Administrative Law Federal Income Tax	<b>1:30 pm</b> Constitutional Law §1 & §2 Copyrights	<b>1:30 pm</b> No Exams
<b>6:30 pm</b> Civil Procedure §3	<b>6:30 pm</b> Contracts §3 Business Associations §2	<b>6:30 pm</b> Estate & Gift Tax Estates & Trusts §2 Payment Systems
<b>Tuesday, December 2</b>	<b>Friday, December 5</b>	<b>Wednesday, December 10</b>
<b>9:00 am</b> No Exams	<b>9:00 am</b> Gender & the Law	<b>9:00 am</b> Evidence §1 Agency & Partnership Negotiation Workshop
<b>1:30 pm</b> No Exams	<b>1:30 pm</b> Criminal Procedure Marital Property Internet Law	<b>1:30 pm</b> Estates & Trusts §1 Texas Pre-Trial Procedure
<b>6:30 pm</b> Texas Trials & Appeals Sports Law Remedies	<b>6:30 pm</b> Texas Criminal Procedure Evidence §2 Oil & Gas	<b>6:30 pm</b> Torts §3 Family Law
<b>Wednesday, December 3</b>	<b>Monday, December 8</b>	<b>Thursday, December 11</b>
<b>9:00 am</b> Secured Transactions Secured Regulations	<b>9:00 am</b> Torts §1 & §2	<b>9:00 am</b> Property §1 & §2 Mediation Clinic
<b>1:30 pm</b> No Exams	<b>1:30 pm</b> No exams	<b>1:30 pm</b> Business Associations §1
<b>6:30 pm</b> No Exams	<b>6:30 pm</b> Bankruptcy Professional Resp. §1 & §2	<b>6:30 pm</b> Property §3

## Syllabi and Assignments for First-Year Classes

Assignments for your first-day of class will be posted here as they are received from your professors. We hope to have all first-day assignments posted by August 8th.

Syllabi for your classes will be posted on the law school web page as soon as they are received from your professors. We hope to have all first-year syllabi posted by August 12th. Syllabi will also be available in paper form in the carousel outside Student Services.

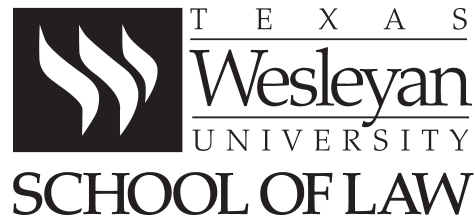

From the Office of the Assistant Dean for Student Affairs

Welcome to my alma mater! As a 1994 graduate, I remember the excitement of starting law school. Along with receiving an excellent education, you will form many close and long lasting friendships while in school. I look forward to getting to know you as you pursue your law degrees.

The Assistant Dean for Student Affairs serves as a liaison between students and law school administration. This office works with the Student Bar Association and the various student organizations at the law school. We coordinate many of the student activities and special events, and we offer support to organizations to help each accomplish its goals.

This office provides assistance with classroom or exam accommodations, personal or family emergencies, and other matters which may require special assistance for students.

You will soon learn that each law student must perform 30 hours of pro bono legal services as a condition of graduation. This office manages the Equal Justice Program, which provides information about pro bono opportunities for students.

Barb Tsirigotis, administrative assistant, frequently sends e-mail messages to all students about important meetings, special events, or general information. It is imperative that you learn how to access your e-mail and check it frequently. You will be instructed in the use of e-mail during Orientation.

We are here to help you have the best educational experience possible. We look forward to serving and assisting you on your journey to becoming a lawyer. Please feel free to contact me at 817-212-4020 or e-mail me at [pturner@law.txwes.edu](mailto:pturner@law.txwes.edu) if you have questions or concerns.

Patti Gearhart Turner  
Assistant Dean for Student Affairs and  
Director of the Equal Justice Program

## Student Affairs Office

Hours: 9:00 a.m. – 6:00 p.m. Monday-Thursday  
9:00 a.m. – 5:00 p.m. Friday

The office of the Assistant Dean for Student Affairs welcomes you to Texas Wesleyan School of Law. Please call us at 817-212-4111 if we may be of assistance to you. Contact us regarding:

Classroom or exam accommodations

Emergencies, family, health

Law Student/Administration Liaison

Student organization matters

- Travel/hotel arrangements
- Schedule events

Equal Justice Program

- Pro Bono opportunities
- In-house pro bono programs

Hooding and Commencement

Patti Gearhart Turner  
Assistant Dean for Student Affairs  
Director of Equal Justice Program

Barbara Tsirigotis  
Administrative Assistant

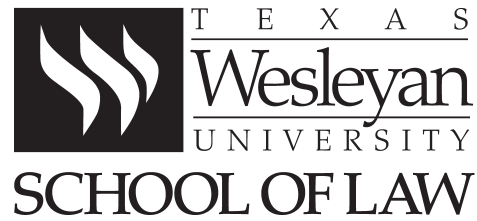

Dear Incoming Wesleyan 1Ls,

I commend you on your choice to attend Texas Wesleyan University School of Law. On behalf of the Student Bar Association, I would like to welcome you to Texas Wesleyan University School of Law. The Student Bar Association (SBA) is dedicated to promoting the interests of students by acting as a liaison between students and both the faculty and administration. The SBA also organizes many of the school's social events throughout the year, such as Casino Night, a Fall BBQ, a Spring Crawfish Boil, Barrister's Ball, and monthly socials at different locations in Fort Worth. Additionally, the SBA represents Texas Wesleyan at various conferences throughout the year, including the American Bar Association's Annual Conference.

The SBA comprises the entire student body. Its Executive Board consists of elected representatives holding the positions of President, Vice President, Parliamentarian, Secretary, and Treasurer. The remaining fifteen voting members are made up of five representatives from each class; there are four representatives for day students and one representative for night students.

The SBA generally holds meetings twice each month. The schedule is set at the beginning of each semester to avoid conflicts with the schedules of the voting members and other students who wish to participate. The meeting schedule and room assignments will be posted in the glass SBA display case on the second floor.

I encourage you to participate in the SBA by attending our meetings, even if you choose not to be a representative. Our school benefits from the involvement and contributions of all of its students. I look forward to meeting you and I wish you the best of luck!

Sincerely,

Hunter Parrish  
SBA President

## Need Health Insurance?

Health insurance is available through student membership in the American Bar Association or the Texas Bar Association. You can learn more about the insurance plans on the web sites of these organizations.

At the home page for the ABA - <http://www.abanet.org/ltd/home.html> - click on 'Insurance' where you will find information on health insurance.

The State Bar of Texas maintains an insurance trust in conjunction with Aetna to provide health insurance to both lawyers and law students. Go to [www.sbotit.com](http://www.sbotit.com) and you will find information for plan enrollment.

Finally, Texas Wesleyan University offers health insurance to students through Academic Health Plans. You can review this policy and enroll online at [www.academichealthplans.com](http://www.academichealthplans.com) or by calling 888-308-7320; or contact Paige Cook at the campus clinic at 817-531-4948 or [pcook@txwes.edu](mailto:pcook@txwes.edu).

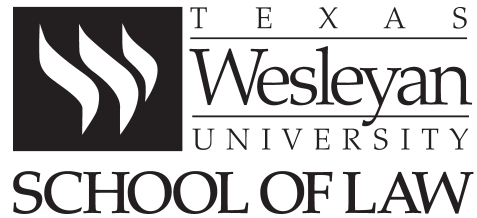

From the Office of Admissions

Congratulations and welcome to Texas Wesleyan University School of Law!

It is finally official, as you have transitioned from being an applicant to being a member of our law school community over the last several months. I want to welcome you to Texas Wesleyan Law as a peer in our community and a peer in the law.

I, and the entire Office of Admissions team, have enjoyed working with you during this time. We have laughed with you often, and you have shared your moments of triumph and joy with us. Each year, we are touched and grateful to share in these and many other important moments with students, and we continue to be humbled by this honor.

So, now as you take the last step to join our community, we hope you will not forget us or where our office is located. We want you to know that our door always remains open to you. While our formal communications with you will be rare once classes begin, watch the E-Legal Newsletter next spring for information on joining the Office of Admissions' Student Ambassador Program. Maybe you will help us recruit the next new class.

If you are still looking for housing or a roommate, know that we remain available to assist you whenever possible. And of course, if you have scholarship questions, please do not hesitate to stop by my office or contact me directly.

Finally, we are confident that as you become a full member of Texas Wesleyan Law, you will find that our colleagues throughout the remainder of the law school building are remarkable people who are also excited to see your many successes over the next several years. The time will go quickly and I encourage you to enjoy it while you work hard. This is the moment you have been waiting for!

I look forward to your future success and seeing you in our halls. If there is anything we can do to help make your adjustment to law school and the Fort Worth area smoother, simply let us know. Again, congratulations and welcome to Texas Wesleyan University School of Law!

All the best,

Sherolyn Hurst, J.D.  
Assistant Dean of Admissions and Scholarships

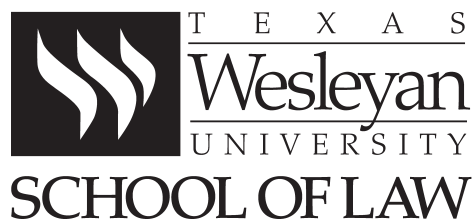

From Financial Aid

Congratulations and welcome!

By this time, most of the entering class has already had an opportunity to meet us in the financial aid office. For those of you who have not, we extend this invitation!

Loan Entrance Counseling is required for those of you who will have Stafford Loans. Many of you will have completed Loan Entrance Counseling online or at other schools, which will satisfy the federal requirement. Please contact me with any further questions you have about your loans. This is your opportunity to ask questions about your rights and responsibilities as well as features of the Federal Family Education Loan Program.

Individual questions of eligibility, etc., are best answered privately. Please feel free to telephone, e-mail, or stop by with your concerns. My telephone number is (817) 212-4090, and my e-mail address is [dakins@law.txwes.edu](mailto:dakins@law.txwes.edu). My office is located in the Admissions office of the law school. Sherry Zimmerman is assistant to both the Financial Aid and Business offices, and she can help with many of your questions as well.

Now is an excellent time to complete the Loans By Web process, if you have not yet done so. If we have documented your attendance at a Loan Entrance Counseling session, we should be able to release Stafford Loan funds beginning on Friday of the first week of class.

Doug Akins  
Office of Financial Aid

## Business Office

### Hours of Operation:

Monday - Thursday: 9:00 a.m. - 6:30 p.m.

Friday: 9:00 a.m. - 5:00 p.m.

### The Business Office offers the following services:

Payments can be made by check, cash, or credit card. We accept MasterCard, Visa, Discover, and American Express.

Credit card payments can be taken over the phone with the following information:  
credit card number, payment amount, and expiration date.

Checks cashed, limit of \$20.00.

Financial Aid Forms provided and accepted.

Refund checks.

Change for vending machines, etc. Vending reimbursements.

If we can be of further assistance, contact Carolyn Hiebert, Business Manager, at 817-212-4080 or Sherry Zimmerman, Administrative Assistant at 817-212-4081.

## Parking Regulations

Annual parking permits are required for all students who use the law school parking lots. Each vehicle you use in the lots will require a permit. Place the static cling sticker on the driver's side front windshield, above the state inspection sticker.

Parking in the Texas Wesleyan parking lots is on a first-come, first-served basis. There is no charge for parking.

Texas Wesleyan parking lot locations:

Student Lot C at 14th and Calhoun

Faculty/staff Lot B (student restricted spaces are available) at 15th and Calhoun

Student Lot A at 17th and Calhoun

Student parking in Lot B is restricted as follows:

- Student parking is available between the hours of 6:30 a.m. and midnight, Monday through Friday in any unnumbered space on a first-come, first-served basis.
- Except for spaces numbered 1 through 12, student parking is available between the hours of 5:30 p.m. and midnight in any space on a first-come, first-served basis.
- Student parking is available between the hours of 6:30 a.m. and midnight on Saturday and Sunday in any space on a first-come, first-served basis.

Parking violators will be ticketed and fined according to the Texas Wesleyan University School of Law parking policy. Appeals may be made in writing within the time indicated on the citation. If the fine is upheld by the Appeals Committee and is not paid by the end of the semester during which it was issued, the law school will hold your grades, registration, and your diploma until the fine is paid.

**You will receive a parking permit during orientation.**

## Transportation

**Fort Worth Transportation Authority** serves the greater Fort Worth metropolitan area. The Fort Worth Transportation Authority public transportation system comprises both buses and the Trinity Railway Express. Information on transportation costs, routes, and schedules can be found by contacting the transportation authority.

**The T – serves the Fort Worth area**

<http://www.the-t.com/>

**Trinity Railway Express – serves Fort Worth, Dallas, and Mid-Cities**

<http://www.trinityrailwayexpress.org/>

**DART (Dallas Area Rapid Transit)** serves the greater Dallas metropolitan area. The Dallas Area Rapid Transit public transportation system comprises light rail, buses, and the Trinity Railway Express. Information on transportation costs, routes, and schedules can be found by contacting the transportation authority.

**DART**

<http://www.dart.org/>

Texas Wesleyan University School of Law students can **take advantage of area public transportation system by purchasing a significantly discounted pass through the law school.** For more information or to purchase an annual transportation pass, contact the Office of Admissions or visit the law school Cashier's Office.

### NEED A RIDE?

Travel Smart - Ride Share - Car Pool - Save Gas

[www.Pickupal.com](http://www.Pickupal.com)

[www.erideshare.com](http://www.erideshare.com)

[www.ridecheck.com](http://www.ridecheck.com)

[www.craigslist.com](http://www.craigslist.com)

(search for rideshare – click on your city)

## Declaration of Intent to Study Law

As a law student you are required to file a Declaration of Intent to Study Law with the Texas Board of Law Examiners. Texas Wesleyan does not supply this form. It can be obtained only at:

[http://www.ble.state.tx.us/applications/declaration/decl\\_main.htm](http://www.ble.state.tx.us/applications/declaration/decl_main.htm)

Click first on eFast Direct then on Paper Declaration Form. You must complete and submit your declaration to the Board of Law Examiners electronically. Also, print a copy for your records and a copy to mail to the Board of Law Examiners, along with the required attachments, the notarized Authorization and Release forms, and fees.

### Timely Filing Deadline

October 1 or before.....\$190.00

After October 1.....\$340.00

You will need to familiarize yourself with the Rules Governing Admission to the Bar of Texas, also located at the Board of Law Examiners web site.

Your signature on your Declaration of Intent to Study Law *must be notarized*. Notaries on staff are:

Student Services: Tammy Hubbard  
Meghan Walker  
Julie Edwards  
Becky Key

Dean's Office: Rita O'Donald  
Deborah Barnett

Academic Affairs: Christina Rodriguez

Student Affairs: Barbara Tsirigotis

Law Clinic: Mireya Torres

Faculty Assistants: Jessica Chavez  
Doug Thurman

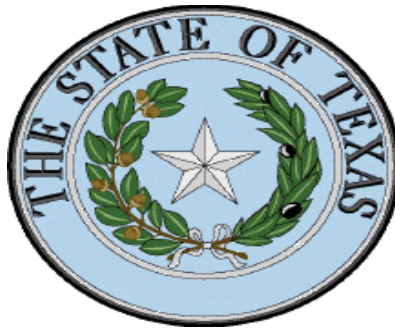

**Board of Law Examiners**  
Appointed by the Supreme Court of Texas

**A MESSAGE FROM THE TEXAS BOARD OF LAW EXAMINERS TO  
PROSPECTIVE APPLICANTS FOR ADMISSION TO THE BAR OF TEXAS**

This is to advise you of certain procedures and requirements that will apply to you if you are admitted to an ABA-approved law school in Texas and intend to become licensed to practice law in Texas upon your graduation from that law school.

The *Rules Governing Admission to the Bar of Texas* (“Rules”) provide that a law student attending an ABA-approved law school in Texas who intends to apply for admission to the Bar of Texas must complete and file a form entitled the *Declaration of Intention to Study Law* (“Declaration”). The timely filing deadline for the Declaration is October 1 for students entering law school in the Fall term, May 1 for semester hour Spring entrants, June 1 for quarter hour Spring entrants, and September 15 for Summer entrants. You may not file the Declaration until you have started law school. However, these deadlines occur within a few weeks of the beginning of your first year of law school, so it is important to consider them now while you are planning for law school admission.

The Declaration makes a number of inquiries of the law student completing the form, including inquiries into criminal offenses and discipline received as a student. You should carefully review this form and the questions it contains on the website of the Texas Board of Law Examiners [www.ble.state.tx.us](http://www.ble.state.tx.us).

Each law student who files a Declaration is also required to submit to the Board a copy of his or her law school application. **The staff of the Board will compare the responses given on the law school application to the responses given on the Declaration**, with particular emphasis on the questions relating to criminal offenses and discipline received as a student. Please note that the questions asked on the law school application may not be identical to the questions asked on the Declaration.

Careful attention must be given to the responses you make on your law school application. The law schools to which you apply and the Texas Board of Law Examiners expect your responses to be truthful and complete. **When in doubt, disclose.** The Board will obtain your criminal history information from both the FBI and the Texas Department of Public Safety. You will also be required to submit authorization and release forms with your Declaration. These forms will accompany requests by the Board to verify your academic, military, employment, and other relevant records. You will be required to amend your law school application if it appears to Board staff that you should have revealed a matter on your law school application, but did not, or if what you revealed to your law school appears false or misleading in light of the information obtained by Board staff.

It will be to your advantage to file your Declaration by the applicable deadlines given above. **This is particularly true if you have significant matters to reveal.** The staff of the Board is able to assist and counsel law students in the resolution of many issues during the time the students are in law school; however, students must file the Declaration on time to enable the Board staff to provide such assistance. Additionally, if you file your Declaration late, it may result in the delay of your licensure.

The Rules require that an applicant for admission to the Bar of Texas be of present good moral character and fitness. The Declaration provides the basis of the staff's investigation into a Texas law student's present moral character and fitness.

A law student whose investigation reveals a significant character or fitness issue may be required to appear before a Panel of the Board of Law Examiners for a character and fitness hearing. Examples of the kinds of issues that may require a hearing include, but are not limited to:

- Dishonesty, including non-disclosure of information requested by a law school or the Board;
- Felony criminal history (see Rule IV on the Board's website for more information about felonies);
- Significant misdemeanor criminal history;
- Chemical dependency; and
- Failure to discharge significant financial obligations, including:
  - Payment of child-support;
  - Filing federal income tax returns and payment of required taxes;
  - Failure, in an employment setting, to file withholding taxes for employees; and
  - Default in a substantial amount of business or personal debts.

After having read and considered this message, we encourage you to contact Board staff at 512-463-1621 if you need assistance in completing your Declaration or if you have questions about the licensure process. You may also need to contact the admissions officials at your law school if you have concerns about your law school application.

## Fingerprinting & Photographing

- REQUIRED-

As a law student, you are required by the Board of Law Examiners to be fingerprinted. Names of all law students who file timely Declarations (by October 1 for fall entrants) will be forwarded to the designated fingerprinting service by the Board of Law Examiners. The Texas Board of Law Examiners uses IBT for the fingerprinting process. Students who do not file their Declaration in a timely manner must make other fingerprinting arrangements through the Board of Law Examiners.

As a service to our law students, representatives of IBT will be at the law school in early November for fingerprinting. You will be notified via email of your assigned day. IBT is able to process only 100 students per day. It is imperative that you appear on your assigned date to take advantage of this service. Only students that have filed a timely Declaration will be scheduled for fingerprinting at the law school.

Your Declaration package includes a FAST Print Pass form which you must complete and submit to the Law School Student Services Office by October 1, 2008. This form can also be found at

<http://www.ble.state.tx.us/Forms/FAST%20Form.pdf>

You will be charged \$9.95 at the time your fingerprints are taken. You can pay by certified check, money order, or personal check made payable to "IBT." CREDIT CARDS AND CASH WILL NOT BE ACCEPTED.

A photo will also be taken and forwarded to the Texas Department of Public Safety (DPS). If you have a criminal record in the State of Texas, the DPS will retain your photo; otherwise, it will be deleted.

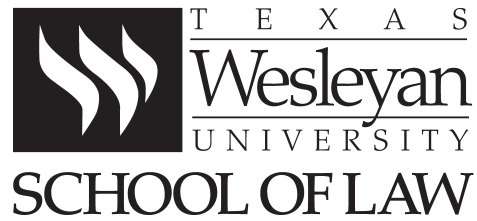

## From Career Services

Dear First-Year Student,

Welcome to Texas Wesleyan University School of Law. We are delighted that you have joined our law school community. In the next several years, you will learn the law and its application with the goal of becoming a lawyer. Along with learning how to be a lawyer, you must also learn how to find a job in the legal field of your choice. Just as you will attend classes, study, become creative, and persist in developing your legal skills, you must also attend seminars, study, become creative, and persist in developing your job search skills. Everyone in the career services office is here to help you do that.

**During the first week of November, you will be required to attend a mandatory career services orientation seminar.** During this mandatory orientation seminar, we will provide you with an overview of the job search process, information on available resources, and advice on what to do during your first year of law school. After attending the mandatory orientation seminar, you are encouraged to set up a private counseling session. In addition, we will be offering seminars throughout the year to teach you specific skills and provide you with information covering a variety of topics.

A summary of services we offer can be found in your Student Programs, Policies, & Procedures booklet. You can also learn more about our office by clicking on the Career Services tab on the law school's website ([www.law.txwes.edu](http://www.law.txwes.edu)). I urge you to become acquainted with our office and actively participate in our programs. It will make a real difference in your future.

Sincerely,

Arturo Errisuriz  
Assistant Dean for Career Services

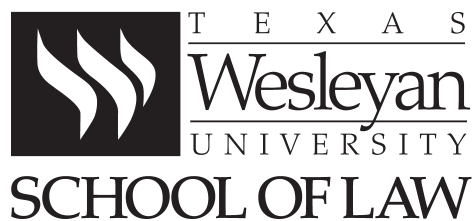

From Law Review

The members of the Texas Wesleyan Law Review welcome you to the Texas Wesleyan University School of Law.

The Law Review is a student-run organization intended to encourage scholarly criticism and analysis of emerging legal issues. We provide an academic forum for legal scholarship on topics of interest to academicians, legal practitioners, and law students. Our primary purpose is to publish one volume of our journal, consisting of at least a Fall and Spring issue, every school year.

An invitation to join the Law Review represents the highest academic honor attainable in law school. Every accredited law school in the United States recognizes a student's lockstep academic achievements by inviting the top-performing students to participate in the publication efforts of that school's law review. Legal practitioners and scholars throughout the nation recognize the value of membership in a law review. You may qualify to join the Texas Wesleyan Law Review by ranking in the top of your class upon completion of all 1L lockstep courses.

Membership in the Law Review demands a significant commitment of time and energy. In meeting this commitment, student members significantly improve their research, writing, and editing skills. Students can earn up to six hours of credit over the course of their law school careers, receive recognition on the masthead of the publications on which they work, and have the opportunity to satisfy their rigorous writing requirement. Additionally, a select number of member-authored articles are published in every volume of the journal.

We wish you the best of success as you begin your 1L year! Our office is in Room 242; please feel free to stop by to learn more about the Law Review, or for encouragement and advice from our members. We look forward to seeing you all soon!

Sincerely,  
Jim Kiser  
Editor-in-Chief  
Texas Wesleyan Law Review

# Law Review Board of Editors

## Editor-in-Chief

Jim Kiser

## Managing Editor

Sharon Kolbet

## Executive Editor

Courtney Willis

## Articles Editors

Hunter Bland  
Kyle Brashier  
Patrick Cannon  
Kim Collier  
Dora Dekany  
Jessica Hall

## Citations Editor

Sharon Lowry

## National Conference of Law

### Reviews Editor

Audra Heinze

## Business & Marketing Editor

Jason Kathman

## Notes & Comments Editors

Josh Andor  
Becky Carlson  
Bryan Davis  
Hope Hughes

## Symposium Editor

Zach Burt

## Faculty Advisor

Wayne Barnes

## Website

<http://law.txwes.edu/LawReview>

## E-mail

[lawreview@law.txwes.edu](mailto:lawreview@law.txwes.edu)

**FULL-TIME FACULTY & STAFF**

4090	Akins, Doug - Financial Aid
4115	Alton, Stephen - Professor
4070	Austin, Terry - Bookstore
3829	Ayala, Kelly - Lib Receiving Asst.
3943	Ayres, Susan - Professor
4109	Barnes, Wayne - Professor
4048	Barnett, Deborah - AA Dean's Office, Law Review
4058	Becker, Cecily - Asst Dir Career Serv.
3826	Betts, Janis - Library Business Tech
3959	Burge, Mark - Legal Writing Professor
3809	Burress, Cynthia - Public Service Librarian
3932	Cady, John - Professor
4051	Carpenter, Megan - Assoc. Professor
3901	Chambers, Everett - Dir, Academic Support
3970	Chavez, Jessica - Faculty Secretary
3950	Coale, Margarita - Assoc. Prof.
4127	Contreras, Celestina - Staff Attorney-Law Clinic
3937	Cruz, Vince - Dir Advocacy Programs
4061	Dozier, Abby - Communications Specialist
3827	Duck, Haley - Serials Asst. - Lib.
4145	Dyer, Casey - Dir. Dev. & Alumni Relations
4049	Edwards, Julie - AA Student Services
3926	Elliott, Frank - Professor
4041	Errisuriz, Arturo - Asst Dean Career Services
4038	Estrada, Isabel - AA Career Services
3934	Fontaine, Cynthia - Professor
4020	Gearhart Turner, Patti - Asst. Dean, Students
4120	George, Paul - Professor
4021	Gillmer, Jason - Professor
3810	Goodman, Lisa - Public Service Librarian
3912	Gray, Robert - Professor
4140	Green, Michael - Assoc Dean Fac Dev. & Prof
3818	Hambleton, Jim - Assoc. Dean Budget & Planning
4028	Harrington, Maxine - Professor
3942	Heige, Terri L. - Assoc. Professor
4080	Hiebert, Carolyn - Business Manager
3936	Hirokawa, Keith - Assoc. Professor
4043	Hubbard, Tammy - Registrar Asst, Student Services
4121	Hughart, Charlotte - Clinical Professor
4144	Hughes, Deirdre - Asst. Dir. Admissions
4054	Hunter, Andrea- Public Leadership Fellow
4045	Hurst, Sherolyn - Asst Dean Admissions
3815	Jefferson, Sharon - Serials Asst. - Library
4052	Kelly Dennis - Legal Writing Professor
4088	Key, Becky - Facilities Manager
4013	Key, Courtney - Career Services Coordinator
3808	Law, Wendy - Head - Public Services Librarian
3922	Lucas, Gary - Assoc. Professor

3812	Marshall, Stephanie - Public Service Librarian
3822	McGaha, Lillian - Acquisition Tech
4070	McGarity, Patricia - Bookstore Supervisor
3954	McGrath, James - Assoc. Professor
4196	McGuire, Glen - Computer Tech
3957	Miller, Marta - Asst Dir, Academic Support
4138	Newman, Neal - Assoc. Professor
4100	O'Donald, Rita - Asst to the Dean (White)
4125	Pellegrino, Matt - Bldg. Support Tech
3953	Pham, Huyen - Professor
3806	Phillips, Susan - Professor
3904	Pierce, Tanya - Legal Writing Professor
3923	Pratt, Carla - Professor
3952	Rainwater, Vickie - Assoc. Dean, Academics
3920	Rambo, Lynne - Professor
4015	Rodriguez, Chris- AA -Acad Dean. (Rainwater)
4126	Rowden, Karon - Staff Attorney-Law Clinic
4106	Rucker, Sarah - Alumni & Advmnt Coordinator
4143	Rusnak, Lori - AA Admissions Coordinator
4084	Seifert, Jeffrey - Technology Serv Tech
4005	Seymore, Malinda - Professor
4114	Short, Aric - Assoc Professor
4056	Simon, Roger - Legal Writing Professor
3828	Simpson, Barry - Site Services Coord.
4103	Smith, Lisa - Law Clinic Off Mngr.
4046	Smith, Ruth - Law School Registrar
4110	Snider, Emily - Admissions Records Mngr
3921	Snyder, Frank - Professor
4055	Sobol, Neil - Legal Writing Professor
3940	Spurlock, Joe - Professor
3824	Stringfellow, Joan - Head -Tech & Elec Svcs. Lib.
3821	Strohbeck, Karin - Circulation Librarian
3807	Teller, Anna - Interim Dir of Library
3972	Thurman, Doug - Faculty Secretary
4123	Torres, Mireya - Law Clinic Secretary
4111	Tsrigotis, Barbara - AA-Assoc. Dean (G. Turner)
4134	Walker, Meghan - Student Services
4100	White, Fred - Dean & Prof.
4081	Zimmerman, Sherry - AA Bus Off/ Fin Aid

**ADDITIONAL NUMBERS**

4040	Admissions
4094	Advancement
4070	Bookstore
4080	Career Services
4198	Cashier's Office
4196	Computer Lab
4066	Computer Office - Student Techs
4191	Conference Center
4090	Innocence Project
4043	Financial Aid
	Information Line

**FAX NUMBERS**

FAX	ADMIN	817-212-4002
FAX	ADMISSIONS	817-212-4141
FAX	BOOKSTORE	817-212-4074
FAX	CAREER SERV.	817-212-4059
FAX	DEAN'S OFF.	817-212-4199
FAX	FACULTY	817-212-3965
FAX	FIN. AID	817-212-4091
FAX	LAW CLINIC	817-212-4124
FAX	LAW REVIEW	817-212-3898
FAX	LIBRARY	817-212-3801
FAX	MOOT COURT	817-212-3894

Main Number	817-212-4000
Metro Number	817-429-8050
National (WATTS)	1-800-733-9529

**TWU CAMPUS**

Main number	817-531-4444
Metro number	817-429-8224
Address	1201 Wesleyan Fort Worth, Texas 76105-1536

FAX Admin Bldg.	817-531-4425
FAX Business Off.	817-531-6570
FAX Development	817-531-7559
FAX Library	817-531-4814
FAX President's Off.	817-531-4496
FAX Provost Off.	817-531-4288
FAX Human Resources	817-531-4402
FAX Purchasing	817-531-4423

<b>Law School Security</b>	<b>817-819-1298 cell</b>
<b>Law School Security desk</b>	<b>3999</b>
<b>Becky Key</b>	<b>817-819-1444 cell</b>
<b>Matt</b>	<b>817-819-1163 cell</b>

**EMERGENCY** 911

of the Degree  
**Juris Doctor**

Magna Cum Laude

with all the rights, privileges and honors  
of the day of December, one thousand nine  
hundred and nineteen, year of the  
the two hundred nineteenth year of the

